



ROUSSEAU HIGHER INSTITUTE OF TECHNOLOGY

LEARN, CREATE, INNOVATE



WHY CHOOSE ROUSSEAU HIGHER INSTITUTE OF TECHNOLOGY?

We believe in you. We are confident that you can achieve great things if nurtured, supported by the right infrastructure, and given unique opportunities at RHIT: international mobility, language learning, innovative pedagogy, and prestigious partnerships.

At RHIT, we guide you in choosing the right path based on your interests and skills, helping you build a strong profile and launch your career early with an internationally recognized degree and enriching experiences.

You can explore your passions, develop essential skills, and learn how to make a significant impact in your chosen field with an open, adaptable, and innovative mindset.

Earn an internationally recognized degree through a tailored learning experience, including international mobility programs and internships from the first year. You will become part of a community of leaders ready to tackle global challenges, with unique professional opportunities.

At RHIT, you can participate in international student exchange programs, engage in internships, gain valuable experience in your field, and connect with global industry leaders through our extensive network.



RHIT has received the CPD certification, a testament to the quality of our training as well as the practical application of our learning.



Welcome to RHIT

Dear Students and Partners,

It is with great conviction and enthusiasm that I introduce you to the **Rousseau Higher Institute of Technology (RHIT)**. From the very beginning, my vision has been to provide a world-class education that equips students with the skills and knowledge needed to excel in a dynamic, globalized world.

RHIT is more than just a traditional academic institution—it is a hub of innovation where modern teaching methods, hands-on learning experiences, and a global perspective come together to foster excellence. We prioritize internationalization, cultural exchange, and social responsibility, shaping leaders who are not only competent and responsible but also ready to tackle the challenges of a rapidly changing world.

Our mission is to nurture young adults who possess not only strong theoretical foundations but also a profound understanding of their role in society. As the founder, I am fully committed to guiding each student on their journey, unlocking their potential, and supporting their growth—both personally and professionally. RHIT is, above all, a vibrant community, a place of discovery, creativity, and innovation.

I am immensely proud of what we have built together and remain optimistic about the bright future that lies ahead for all our students.

Warm regards,

Mr. Fidèle KENGNE
Founder of RHIT



Founder's Profile

Mr. Fidèle Kengne is a visionary education leader and the founder of the Rousseau Higher Institute of Technology (RHIT), Collège Bilingue le Petit Rousseau, and Rousseau International School. His journey in shaping academic excellence began in 2004 with the establishment of Petit Rousseau, which expanded to include a secondary section in 2012. Under his leadership, the institution earned a place among the top 10 secondary schools in the country, as recognized in the 2023 rankings.

In 2019, Mr. Kengne founded Rousseau International School, an esteemed institution providing education from preschool to high school. It adopts the prestigious Cambridge curriculum and offers the International Baccalaureate, ensuring students receive a globally competitive education.

Building on this success, he launched RHIT in 2022 to extend his mission of delivering world-class education to a wider audience. RHIT is dedicated to nurturing future leaders, equipping them with the skills and knowledge needed to address the demands of a globalized professional world with confidence and innovation.



Learn, Create, Innovate.

COMPETITIVE ADVANTAGE AT ROUSSEAU HIGHER INSTITUTE OF TECHNOLOGY

At RHIT, we offer unparalleled international mobility opportunities. Students can spend one or two semesters at our partner schools abroad or even continue their studies there. We also provide integrated programs, such as our Pre-Engineering Cycle, allowing students to begin their journey at RHIT and seamlessly transition to prestigious partner institutions for their engineering studies. This unique experience enriches their academic and professional growth on a global scale.

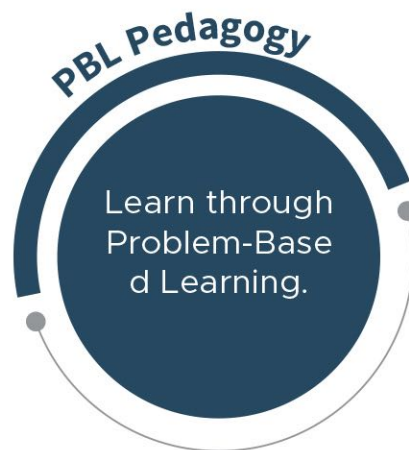

PRÉPA INGÉNIEUR RHIT

Le Programme Préparatoire en Ingénierie de RHIT offre une base solide en sciences de l'ingénieur au cours des deux premières années. Les étudiants poursuivent ensuite leurs études pendant trois ans dans l'une de nos institutions partenaires en France, **ISEN Ouest** ou **IMT Mines Albi**. Le programme intègre un apprentissage pratique grâce à des stages, avec un minimum de six mois d'expérience professionnelle sur cinq ans.

En complément de l'apprentissage basé sur des projets (PBL) et des cours d'anglais, les étudiants bénéficient de la préparation au TOEFL et de cours optionnels de langue chinoise. Dès la deuxième année, ils peuvent participer à des programmes d'apprentissage, combinant études académiques et immersion en entreprise, offrant ainsi une expérience précieuse pour renforcer leur préparation professionnelle.



SIGNATURE PARTENARIAT ISEN



SIGNATURE PARTENARIAT
IMT Mines Albi



PRÉPA INGÉNIEUR **ISEN**

ISEN

QUEST

ISEN Ouest est une grande école d'ingénieurs française. Labellisée par Campus France, ISEN met l'accent sur l'intégration des étudiants étrangers et la poursuite de l'excellence académique dans leur parcours délocalisé. Les étudiants de RHIT en cycle Prépa Ingénieur suivent les mêmes programmes que leurs camarades en France, bénéficient d'un parrainage individualisé, et du suivi académique d'ISEN en plus de celui de RHIT.



PRÉPA INGÉNIEUR **IMT**



IMT Mines Albi-Carmaux
École Mines-Télécom

The RHIT-IMT Mines Albi program offers a unique opportunity for students to pursue a world-class engineering education. After completing a rigorous 2-year preparatory program at RHIT, students transition directly into the prestigious 3-year engineering curriculum at IMT Mines Albi-Carmaux in France, completing a comprehensive 5-year pathway.





TWO AVAILABLE PROGRAMS

The Bachelor of Technology (BTech) is a practical, three-year program focused on emerging technologies, followed by the Master of Technology (MTech) for specialization. The Bachelor of Engineering (BEng), a more theoretical program, lasts four years and leads to the Master of Engineering (MEng). In French-speaking environments, the BTech is equivalent to a professional bachelor's degree, while the BEng corresponds to an engineering diploma. The BTech is typically more affordable and offers a pathway to the BEng, along with international opportunities.



THE CHOICE IS YOURS

At RHIT, both pathways are available: after completing a BTech, you can directly join the fourth year of the BEng program and continue toward a Master of Engineering (MEng). This progression allows students to build on their practical knowledge from the BTech while gaining the theoretical depth of the BEng. Both programs also feature international mobility partnerships, enabling students to broaden their horizons by studying abroad.

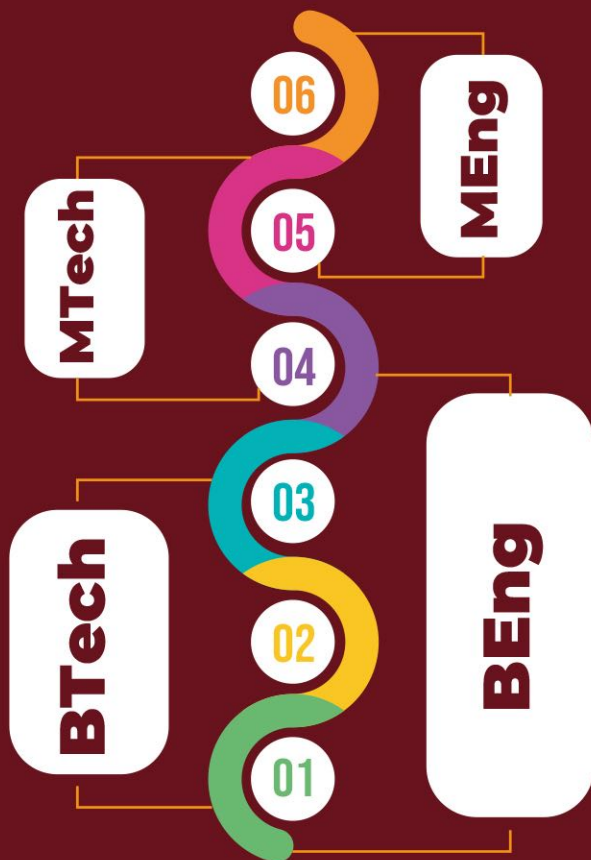

BACHELOR OF ENGINEERING

MASTER OF ENGINEERING

ENGINEERING

AT ROUSSEAU HIGHER INSTITUTE OF TECHNOLOGY (RHIT)

COMPUTER & ELECTRONICS ENGINEERING

ELECTRICAL ENGINEERING

CIVIL ENGINEERING

MECHANICAL ENGINEERING

COMPUTER TECHNOLOGY

MECHATRONICS ENGINEERING

CIVIL ENGINEERING

MECHANICAL ENGINEERING

ENGINEERING

AT ROUSSEAU HIGHER INSTITUTE OF TECHNOLOGY

BACHELOR OF TECHNOLOGY

COMPUTER & ELECTRONICS ENGINEERING

ELECTRICAL ENGINEERING

CIVIL ENGINEERING

MECHANICAL ENGINEERING

MASTER OF TECHNOLOGY

COMPUTER TECHNOLOGY

MECHATRONICS ENGINEERING

CIVIL ENGINEERING

MECHANICAL ENGINEERING

OUTCOMES IN ENGINEERING FIELD

PATH 1 FURTHER STUDIES



Doctorate (PhD)

Research-focused programs that allow specialization in cutting-edge areas such as nanotechnology, renewable energy, or advanced robotics.



MBA IN ENGINEERING MANAGEMENT

Combines engineering knowledge with business and management skills, preparing graduates for leadership roles.



SPECIALIZED CERTIFICATIONS

Advanced certifications like Six Sigma, PMP (Project Management Professional), or Cloud Computing certifications (AWS, Microsoft Azure).

PATH 2 EMPLOYMENT



PROJECT ENGINEER

Oversee technical projects in industries such as construction, manufacturing, or IT.



SYSTEMS ENGINEER

Manage and optimize complex systems in sectors like telecommunications or aerospace



R&D ENGINEER

Focus on innovation and development of new products or processes in sectors like energy or pharmaceuticals

PATH 3 ENTREPRENEURSHIP



TECH START-UP

Launching a business focused on innovative technologies such as IoT, clean energy, or robotics.



CONSULTANCY FIRM

Providing expert advice on engineering projects, process optimization, or technical challenges



CUSTOM MANUFACTURING

Using technologies like 3D printing to produce specialized parts or prototypes for industries

COURSE BTECH

ELECTRICAL ENGINEERING

3 YEARS
PROGRAMME



FOCUSED
SPECIALIZATION
COURSES



HANDS-ON EXPERIENCE
WITH REAL-TIME
INDUSTRY PROJECTS

30
SEATS



ACCESS TO
STATE-OF-THE-ART RESEARCH FACILITIES

Designing and optimizing electrical systems that power industries, communities, and devices. From renewable energy grids to efficient transportation systems, this program equips you to lead in solving the energy challenges of tomorrow while innovating for a sustainable future.

HERE, YOU WILL ACQUIRE

- Expertise in power systems engineering for efficient energy distribution and grid management.
- Advanced knowledge in renewable energy systems, including solar, wind, and energy storage solutions.
- Skills in designing electrical circuits and systems for industries like transportation, manufacturing, and healthcare.
- Strong foundation in control systems for automation and industrial applications.
- Practical insights into creating reliable, safe, and innovative electrical systems for modern infrastructure.

MOBILITY OPPORTUNITIES

Study a semester abroad at one of our international partner institutions or continue your studies overseas after earning your degree.

Entry-Level Positions	JUNIOR ELECTRICAL ENGINEER ASSISTANT ELECTRICAL ENGINEER
Mid-Level Positions	POWER SYSTEMS ANALYST SENIOR ELECTRICAL ENGINEER
Advanced Positions	TECHNICAL SPECIALIST PROJECT MANAGER
Leadership Roles	DIRECTOR OF ELECTRICAL ENGINEERING CHIEF TECHNOLOGY OFFICER (CTO)

YOU ARE A NATURAL
ELECTRICAL
ENGINEER IF YOU

Excel at mathematical and logical thinking

Enjoy translating complex ideas into practical solutions

Approach challenges with hands-on problem-solving

Value safety and precision while remaining curious about new technologies

Problem Based Learning (PBL) Approach

Mandatory internship as from year 1

THE EEE EXPERIENCE



Practical industry training and certification programs



Access to advanced research labs



Guidance from experienced industry mentors



Regular industry visits and on-site training

FURTHER STUDY



Master of Engineering (Electrical)



MSc in Energy Systems or Management

MOBILITY PARTNERS

- IUT VILLETANEUSE
- ISEN-OUEST
- IMT ALBI-CARMAUX
- OMNES EDUCATION

EQUIVALENT TRAINING

Licence Professionnelle en Génie Electrique

COURSE BTECH

CIVIL ENGINEERING

3 YEARS
PROGRAMME



SPECIALIZED COURSES IN
STRUCTURAL, ENVIRONMENTAL,
AND GEOTECHNICAL
ENGINEERING



STATE-OF-THE-
ART LABS AND
DESIGN TOOLS

30
SEATS



REAL-WORLD EXPOSURE THROUGH
PRACTICAL CONSTRUCTION PROJECTS

Building the future—design and construct the bridges, roads, skyscrapers, and dams that shape modern cities and communities. This program prepares you to tackle challenges in sustainable development, disaster resilience, and infrastructure optimization.

HERE, YOU WILL ACQUIRE

- Expertise in designing, analyzing, and constructing sustainable buildings and infrastructure.
- Knowledge of advanced materials, techniques, and tools for modern construction.
- Skills in geotechnical engineering for safe and efficient foundation and soil management.
- Proficiency in water resource management and environmental engineering principles
- Practical knowledge in smart city planning and integrating renewable energy systems into urban infrastructure.

MOBILITY OPPORTUNITIES

Study a semester abroad at one of our international partner institutions or continue your studies overseas after earning your degree.

Entry-Level Positions	JUNIOR CIVIL ENGINEER ASSISTANT SITE ENGINEER
Mid-Level Positions	STRUCTURAL ANALYST SENIOR CIVIL ENGINEER
Advanced Positions	TECHNICAL CONSULTANT PROJECT MANAGER
Leadership Roles	DIRECTOR OF CIVIL ENGINEERING CHIEF ENGINEER

YOU ARE A NATURAL
CIVIL
ENGINEER IF YOU

Have a knack for solving practical problems and enjoy hands-on projects

Excel in spatial reasoning and visualizing structures

Are passionate about designing sustainable and functional spaces

Have an eye for detail and commitment to safety

Problem Based Learning (PBL) Approach

Mandatory internship as from year 1

THE CE EXPERIENCE



Industry-focused training and certification programs



Hands-on exposure in advanced construction labs



Mentorship from experienced professionals



Field visits to ongoing projects and infrastructure sites

FURTHER STUDY



Master of Engineering (Civil)



MSc in Urban Planning or Structural Engineering

MOBILITY PARTNERS

- IUT VILLETANEUSE
- ISEN-OUEST
- IMT ALBI-CARMAUX
- OMNES EDUCATION

EQUIVALENT TRAINING

Licence Professionnelle en Génie Civil

COURSE BTECH

MECHANICAL ENGINEERING

3 YEARS
PROGRAMME



SPECIALIZED COURSES IN
ADVANCED MECHANICS,
THERMODYNAMICS, AND
MATERIAL SCIENCE



ACCESS TO
CUTTING-EDGE
LABORATORIES
AND INDUS-
TRY-STANDARD
SOFTWARE
TOOLS

30
SEATS



HANDS-ON EXPERIENCE WITH
REAL-WORLD MANUFACTURING AND
DESIGN PROJECTS

Designing and optimizing mechanical systems that power our world—from efficient engines to renewable energy devices. Your skills will help revolutionize industries such as transportation, healthcare, and manufacturing by creating innovative and sustainable solutions.

HERE, YOU WILL ACQUIRE

- Expertise in designing and analyzing mechanical systems for industries like automotive, aerospace, and energy.
- Advanced knowledge of thermodynamics and fluid mechanics for efficient energy systems.
- Skills in robotics and automation for modern manufacturing.
- Proficiency in materials science to create durable and innovative products.
- Hands-on experience in CAD, CAM, and other design tools to bring ideas to life.

MOBILITY OPPORTUNITIES

Study a semester abroad at one of our international partner institutions or continue your studies overseas after earning your degree.

Entry-Level Positions	JUNIOR MECHANICAL ENGINEER ASSISTANT DESIGN ENGINEER
Mid-Level Positions	PRODUCT DEVELOPMENT ENGINEER SENIOR MECHANICAL ENGINEER
Advanced Positions	TECHNICAL CONSULTANT PROJECT MANAGER
Leadership Roles	DIRECTOR OF MECHANICAL ENGINEERING CHIEF ENGINEERING OFFICER

YOU ARE A NATURAL
MECHANICAL
ENGINEER IF YOU

Have a passion for
building and improving
machines

**Excel in logical
thinking and solving
technical problems**

Enjoy working with
tools and designing
practical solutions

**Are detail-oriented,
safety-conscious, and
innovative**

**Problem Based
Learning (PBL)
Approach**

**Mandatory
internship
as from year 1**

THE ME EXPERIENCE



Industry training
and professional
certifications



Access to
advanced design
and manufactu-
ring labs



Mentorship by
experienced
professionals



Visits to
cutting-edge
manufacturing
facilities

FURTHER STUDY



Master of
Engineering
(Mechanical)



MSc in Robotics or
Thermal Systems

MOBILITY PARTNERS

- IUT VILLETANEUSE
- ISEN-OUEST
- IMT ALBI-CARMAUX
- OMNES EDUCATION

EQUIVALENT TRAINING

Licence Professionnelle
en Génie Mécanique

COURSE BTECH

COMPUTER & ELECTRONIC ENGINEERING

3 YEARS
PROGRAMME



INDUSTRY-DRIVEN
SPECIALIZATION
COURSES



IMPROVED LAB
SESSIONS

30
SEATS



REALTIME INDUSTRY
PROJECTS

Become the wizard who crafts systems to organize, process, and retrieve information. With Information Science Engineering, you'll be the architect of this information age to shape the future of healthcare, smart cities and the future.

HERE, YOU WILL ACQUIRE

- Proficiency in programming, coding, and software development.
- Designing, implementing, and maintaining databases to store, structure & retrieve information efficiently, and extracting insights from them.
- Understanding networking principles, developing and optimising algorithms for efficient information processing & good communication
- Expertise in building software applications and designing websites that efficiently handle data, ensure access to information, and facilitate data processing, analysis, and presentation.
- Develop skills in securing data networks and information systems against cyber threats.

CAREER LADDER

Functions: Database Administrator, Software Developer, Data Scientist, Information Security Analyst, Systems Analyst, Network Engineer, Web Developer, Business Intelligence Analyst, Machine Learning Engineer, Game Developer

Entry-Level Positions	JUNIOR SOFTWARE DEVELOPER / PROGRAMMER SOFTWARE ENGINEER / DEVELOPER
Mid-Level Positions	SENIOR SOFTWARE ENGINEER/ IT SPECIALIST SOFTWARE DEVELOPMENT TEAM LEAD
Advanced Positions	SOFTWARE ARCHITECT/ SYSTEMS ARCHITECT ENGINEERING MANAGER /PROJECT MANAGER
Leadership Roles	DIRECTOR OF TECHNOLOGY DIRECTOR OF IT

YOU ARE A NATURAL
COMPUTER &
ELECTRONIC
ENGINEER IF YOU ARE

Meticulous and
organised

Analytical thinker and
problem solver

Highly curious about
emerging technologies

Structured
in your work

**Problem Based
Learning (PBL)**

**Mandatory
internship
as from year 1**

THE CEE EXPERIENCE



Talent Exhibitions through innovative projects



Coding & Web development skills



Real-time projects with industries



Work closely with industry researchers

FURTHER STUDY



Master of Engineering



MSc in Business and Administration Management

MOBILITY PARTNERS

- IUT VILLETANEUSE
- ISEN-OUEST
- IMT ALBI-CARMAUX
- OMNES EDUCATION

EQUIVALENT TRAINING

Licence professionnelle en génie électrique et informatique

COURSE MTECH

MECHATRONICS ENGINEERING

2 YEARS
PROGRAMME



SPECIALIZATION IN ROBOTICS, AUTOMATION, AND SMART SYSTEMS



PRACTICAL EXPOSURE THROUGH ADVANCED RESEARCH AND INNOVATION PROJECTS

30
SEATS



ACCESS TO CUTTING-EDGE LABS AND INDUSTRY-STANDARD TOOLS

Designing and optimizing intelligent, automated systems that power industries such as manufacturing, healthcare, and robotics. From autonomous vehicles to smart factories, this program provides you with the skills to lead in the fast-evolving world of mechatronics and automation.

HERE, YOU WILL ACQUIRE

- Expertise in integrating mechanical, electrical, and computer systems to design advanced robotic and automation solutions.
- Knowledge of artificial intelligence and machine learning algorithms for intelligent automation systems.
- Proficiency in designing and controlling smart systems, including robotics, autonomous vehicles, and intelligent manufacturing systems.
- Advanced skills in system modeling, control theory, and sensor integration.
- Hands-on experience with IoT (Internet of Things) applications in industrial automation and robotics.

YOU ARE A NATURAL MECHATRONIC ENGINEER IF YOU

Have a passion for building and improving machines

Excel in logical thinking and solving technical problems

Enjoy working with tools and designing practical solutions

Are detail-oriented, safety-conscious, and innovative

Problem Based Learning (PBL) Approach

Mandatory internship as from year 1

MOBILITY OPPORTUNITIES

Study a semester abroad at one of our international partner institutions or pursue research opportunities with global industry leaders.

Entry-Level Positions	JUNIOR MECHATRONICS ENGINEER ASSISTANT ROBOTICS ENGINEER
Mid-Level Positions	AUTOMATION ENGINEER CONTROL SYSTEMS ENGINEER
Advanced Positions	RESEARCH AND DEVELOPMENT ENGINEER SENIOR ROBOTICS ENGINEER
Leadership Roles	DIRECTOR OF MECHATRONICS ENGINEERING CHIEF TECHNOLOGY OFFICER (CTO)

THE MTME EXPERIENCE



Hands-on projects and industry-based research



Exposure to cutting-edge automation and robotics technologies



Mentorship from experts in robotics and smart systems



Opportunities to collaborate with leading industry partners and researchers

FURTHER STUDY



Doctor of Philosophy (PhD) in Mechatronics, Robotics, or Automation



MSc in Artificial Intelligence or Robotics

MOBILITY PARTNERS

- IUT VILLETANEUSE
- ISEN-OUEST
- IMT ALBI-CARMAUX
- OMNES EDUCATION

EQUIVALENT TRAINING

Diplôme d'Ingénieur spécialisé en Mécatronique

BUSINESS AND ADMINISTRATION MANAGEMENT

AT ROUSSEAU HIGHER INSTITUTE OF TECHNOLOGY

BACHELOR OF SCIENCES

- LEGAL CAREER
- DIGITAL MARKETING
- PROJECT MANAGEMENT
- ACCOUNTANCY
- SUPPLY CHAIN MANAGEMENT

MASTER OF SCIENCES

- LEGAL CAREER
- DIGITAL MARKETING
- PROJECT MANAGEMENT
- ACCOUNTANCY
- SUPPLY CHAIN MANAGEMENT

OUTCOMES IN BUSINESS AND ADMINISTRATION MANAGEMENT

PATH 1 FURTHER STUDIES



DOCTORATE IN BUSINESS ADMINISTRATION (DBA) OR PHD IN MANAGEMENT:

Specialize in research areas like organizational behavior, international business, or strategic management.



PROFESSIONAL CERTIFICATIONS

Pursue globally recognized certifications such as CFA (Chartered Financial Analyst), CPA (Certified Public Accountant), or SHRM (for HR professionals).



SPECIALIZED POSTGRADUATE DIPLOMAS:

Focus on niche fields such as Supply Chain Management, Digital Marketing, or Business Analytics.

PATH 2 EMPLOYMENT



MANAGEMENT CONSULTANT

Work with firms to improve operational efficiency, reduce costs, and drive growth strategies.



BUSINESS DEVELOPMENT MANAGER

Identify new markets, foster partnerships, and drive revenue growth for companies.



FINANCIAL ANALYST

Provide insights on investments, budgeting, and financial planning for businesses.

PATH 3 ENTREPRENEURSHIP



START-UP FOUNDER

Build a business in innovative fields like e-commerce, digital platforms, or green solutions.



CONSULTANCY BUSINESS

Offer expertise in areas like marketing strategies, HR development, or financial management.



FRANCHISE OWNER

Manage a well-established business model, such as retail chains or food franchises.

COURSE **BSc**

LEGAL CAREER

2 YEARS
PROGRAMME



COMPREHENSIVE CURRICULUM
COVERING ESSENTIAL AREAS
OF LAW



PRACTICAL
EXPERIENCE
THROUGH
INTERNSHIPS AND
REAL-WORLD CASE
STUDIES

30
SEATS



ACCESS TO MODERN LEGAL
RESEARCH FACILITIES

Navigating the complexities of the legal system, from drafting legislation to representing clients in court. Ce programme vous prépare à relever les défis juridiques, à défendre la justice et à contribuer au développement de cadres juridiques efficaces.

HERE, YOU WILL ACQUIRE

- In-depth knowledge of legal principles, statutes, and case law
- Skills in legal research, analysis, and writing
- Practical experience through moot courts and internships
- Understanding of various legal fields, including corporate, criminal, and international law
- Ability to critically assess and solve complex legal issues

YOU ARE A
NATURAL LEGAL
CAREER IF YOU

Have strong analytical
and critical thinking
skills

Enjoy researching and
interpreting laws

Are adept at
communication and
argumentation

Are detail-oriented
and committed to
ethical standards

MOBILITY OPPORTUNITIES

Study a semester abroad at one of our international partner law schools or continue your legal studies overseas after earning your degree.

Entry-Level Positions	LEGAL ASSISTANT PARALEGAL
Mid-Level Positions	LEGAL CONSULTANT COMPLIANCE OFFICER
Advanced Positions	LEGAL MANAGER CORPORATE COUNSEL
Leadership Roles	HEAD OF LEGAL DEPARTMENT CHIEF LEGAL OFFICER (CLO)

Problem Based
Learning (PBL)
Approach

Mandatory
internship
as from year 1

THE LC EXPERIENCE



Practical legal
training and
certifications



Access to
advanced legal
research labs



Mentorship from
experienced legal
professionals



Opportunities to
participate in legal
clinics and moot courts

FURTHER STUDY



Doctor of
Philosophy (PhD)
in Mechatronics,
Robotics, or
Automation



MSc in Artificial
Intelligence or
Robotics

MOBILITY PARTNERS

- IUT VILLETANEUSE
- ISEN-OUEST
- IMT ALBI-CARMAUX
- OMNES EDUCATION

EQUIVALENT TRAINING

Licence professionnelle
en Droit

COURSE **BSc**

ACCOUNTANCY

3 YEARS
PROGRAMME



COMPREHENSIVE FOUNDATION
IN FINANCIAL REPORTING,
AUDITING, AND MANAGEMENT
ACCOUNTING



PREPARATION FOR
CERTIFICATIONS
LIKE ACCA OR CPA

30
SEATS



EXPOSURE TO GLOBAL
ACCOUNTING STANDARDS
AND TOOLS

Understanding and managing the financial health of businesses. This program equips you to analyze financial data, ensure compliance with regulations, and support strategic decisions that drive organizational success.

HERE, YOU WILL ACQUIRE

- In-depth knowledge of financial principles, corporate accounting, and taxation.
- Practical skills in auditing, financial analysis, and budgeting.
- Proficiency in using advanced financial software and ERP systems.
- Understanding of global financial regulations and ethical accounting practices.
- Experience through real-world case studies and business simulations.

MOBILITY OPPORTUNITIES

Study a semester abroad at one of our international partner institutions, or continue your studies overseas with global recognition of your degree.

Entry-Level Positions	ACCOUNTING ASSISTANT JUNIOR ACCOUNTANT
Mid-Level Positions	TAX ADVISOR INTERNAL AUDITOR
Advanced Positions	FINANCIAL CONTROLLER FINANCE CONSULTANT
Leadership Roles	FINANCE DIRECTOR CHIEF FINANCIAL OFFICER (CFO)

YOU ARE A NATURAL
ACCOUNTANCY
STUDENT IF YOU

Are detail-oriented and analytical

Excel at working with numbers and data

Have strong organizational and communication skills

Are ethical and methodical in your work

Problem Based Learning (PBL) Approach

Mandatory internship as from year 1

THE AC EXPERIENCE



Industry internships and certifications



Access to advanced financial tools and labs



Mentorship from finance professionals



Workshops and real-world business simulations

FURTHER STUDY



Master of Accounting



MSc in Finance or Taxation

MOBILITY PARTNERS

- Skemba Business School,
- Université Sorbonne Paris-Nord,
- OMNES Education

EQUIVALENT TRAINING

Licence professionnelle en Comptabilité

COURSE **BSc**

DIGITAL MARKETING

3 YEARS
PROGRAMME



COMPREHENSIVE UNDERSTANDING OF DIGITAL MARKETING STRATEGIES AND TOOLS



COLLABORATION WITH INDUSTRY LEADERS ON REAL-WORLD CAMPAIGNS

30
SEATS



HANDS-ON TRAINING IN SEO, SOCIAL MEDIA MARKETING, AND CONTENT CREATION

Creating innovative marketing strategies across digital platforms. You will learn to engage audiences, increase online presence, and drive business growth through SEO, social media, and content marketing.

HERE, YOU WILL ACQUIRE

- Knowledge of online marketing techniques including SEO, SEM, and social media strategies.
- Skills in content creation, data analytics, and digital advertising.
- Understanding of e-commerce, mobile marketing, and digital branding.
- Practical experience through live digital marketing campaigns and internships.
- Experience with industry-standard tools and software for marketing analysis.

MOBILITY OPPORTUNITIES

Study a semester abroad at one of our international partner institutions, or continue your studies overseas after completing your degree.

Entry-Level Positions	DIGITAL MARKETING ASSISTANT SOCIAL MEDIA COORDINATOR
Mid-Level Positions	CONTENT MANAGER DIGITAL ADVERTISING EXECUTIVE
Advanced Positions	E-COMMERCE MANAGER BRAND STRATEGIST
Leadership Roles	CHIEF MARKETING OFFICER (CMO) DIGITAL MARKETING DIRECTOR

YOU ARE A NATURAL DIGITAL MARKETING STUDENT IF YOU

Are creative and enjoy exploring new trends

Have strong analytical and communication skills

Enjoy working with digital tools and platforms

Are passionate about online branding and consumer behavior

Problem Based Learning (PBL) Approach

Mandatory internship as from year 1

THE DM EXPERIENCE



Practical experience with live campaigns and brand strategies



Hands-on projects in SEO, content creation, and analytics



Exposure to the latest digital marketing tools and platforms



Collaboration with marketing experts and mentors

FURTHER STUDY



Master of Digital Marketing



MSc in Business Administration or E-commerce

MOBILITY PARTNERS

- Skemma Business School,
- Université Sorbonne Paris-Nord,
- OMNES Education

EQUIVALENT TRAINING

Licence professionnelle en Marketing Digital

COURSE **BSc**

PROJECT MANAGEMENT

3 YEARS
PROGRAMME



COMPREHENSIVE TRAINING IN PROJECT PLANNING, EXECUTION, AND MONITORING



REAL-WORLD PROJECTS WITH INDUSTRY PARTNERS

30
SEATS



FOCUS ON STRATEGIC DECISION-MAKING AND RISK MANAGEMENT

Planning and executing projects across various sectors, from construction to technology. You will develop the skills to ensure projects are completed on time, within budget, and meet stakeholder expectations.

HERE, YOU WILL ACQUIRE

- Knowledge in project scope, scheduling, budgeting, and resource management.
- Skills in risk analysis, quality control, and stakeholder communication.
- Experience with project management software and tools.
- Hands-on experience through internships and live projects across industries.
- An understanding of global project management standards and methodologies.

MOBILITY OPPORTUNITIES

Study a semester abroad at one of our international partner institutions, or continue your studies overseas after completing your degree.

Entry-Level Positions	PROJECT COORDINATOR JUNIOR PROJECT MANAGER
Mid-Level Positions	PROJECT ANALYST OPERATIONS MANAGER
Advanced Positions	PROGRAM MANAGER PORTFOLIO MANAGER
Leadership Roles	HEAD OF SUPPLY CHAIN CHIEF OPERATING OFFICER (COO)

YOU ARE A NATURAL PROJECT MANAGEMENT STUDENT IF YOU

Are detail-oriented and organized

Enjoy problem-solving and managing resources

Can communicate effectively with diverse teams

Are adaptable and thrive under pressure

Problem Based Learning (PBL) Approach

Mandatory internship as from year 1

THE SCM EXPERIENCE



Practical experience through internships and live projects



Exposure to the latest project management tools and methodologies



Collaboration with industry experts and mentors



Opportunities to manage and lead projects

FURTHER STUDY



Master of Project Management



MSc in Business Administration or International Management

MOBILITY PARTNERS

- Skemba Business School,
- Université Sorbonne Paris-Nord,
- OMNES Education

EQUIVALENT TRAINING

Licence professionnelle en Management de Projet

COURSE **BSc**

SUPPLY CHAIN MANAGEMENT

3 YEARS
PROGRAMME



IN-DEPTH UNDERSTANDING OF LOGISTICS, PROCUREMENT, AND DISTRIBUTION MANAGEMENT



OPPORTUNITIES TO COLLABORATE WITH TOP COMPANIES ON REAL-LIFE PROJECTS

30
SEATS



HANDS-ON TRAINING IN GLOBAL SUPPLY CHAIN SYSTEMS

Optimizing supply chain processes from raw material sourcing to final product delivery. You will help companies improve efficiency, reduce costs, and meet customer expectations while mastering global supply chain strategies.

HERE, YOU WILL ACQUIRE

- Knowledge of supply chain principles and best practices.
- Skills in managing logistics, inventory, and demand forecasting.
- Understanding of procurement, warehousing, and distribution strategies.
- Experience with the latest supply chain management software and tools.
- A practical approach through internships and projects in diverse industries.

YOU ARE A NATURAL SUPPLY CHAIN MANAGEMENT STUDENT IF YOU

Are organized and detail-oriented

Enjoy problem-solving and process optimization

Have strong communication and negotiation skills

Are interested in logistics, operations, and global trade

MOBILITY OPPORTUNITIES

Study a semester abroad at one of our international partner institutions, or continue your studies overseas after completing your degree.

Entry-Level Positions	SUPPLY CHAIN ASSISTANT LOGISTICS COORDINATOR
Mid-Level Positions	SUPPLY CHAIN ANALYST OPERATIONS MANAGER
Advanced Positions	DISTRIBUTION MANAGER LOGISTICS DIRECTOR
Leadership Roles	HEAD OF SUPPLY CHAIN CHIEF OPERATING OFFICER (COO)

Problem Based Learning (PBL) Approach

Mandatory internship as from year 1

THE SCM EXPERIENCE



Practical experience through internships and industry projects



Exposure to global supply chain networks



Access to cutting-edge logistics tools and software



Collaboration with industry experts and mentors

FURTHER STUDY



Master of Supply Chain Management



MSc in Logistics or International Business

MOBILITY PARTNERS

- Skemba Business School,
- Université Sorbonne Paris-Nord,
- OMNES Education

EQUIVALENT TRAINING

Licence professionnelle en Gestion de la Chaîne d'Approvisionnement

COURSE MSc

SUPPLY CHAIN MANAGEMENT

2 YEARS
PROGRAMME



EXPERTISE IN LOGISTICS, PROCUREMENT, AND SUPPLY CHAIN OPTIMIZATION



REAL-WORLD PROJECTS WITH INDUSTRY LEADERS

30
SEATS



IN-DEPTH UNDERSTANDING OF GLOBAL SUPPLY CHAIN STRATEGIES

Managing and optimizing global supply chains, from sourcing materials to final product delivery. This program prepares you to improve efficiency, reduce costs, and enhance customer satisfaction across industries.

HERE, YOU WILL ACQUIRE

- Advanced knowledge of supply chain management, including procurement, warehousing, and distribution strategies.
- Skills in demand forecasting, inventory management, and supply chain risk analysis.
- Proficiency in using advanced supply chain management software and ERP systems.
- Practical experience through internships, case studies, and collaborations with leading companies.
- Understanding of global logistics, sustainability, and ethical supply chain practices.

MOBILITY OPPORTUNITIES

Study abroad at one of our international partner institutions, or continue your studies overseas after completing your degree.

Entry-Level Positions	SUPPLY CHAIN ANALYST LOGISTICS COORDINATOR
Mid-Level Positions	INVENTORY CONTROL SPECIALIST OPERATIONS MANAGER
Advanced Positions	LOGISTICS DIRECTOR E-COMMERCE SUPPLY CHAIN
Leadership Roles	CHIEF SUPPLY CHAIN OFFICER (CSCO) HEAD OF LOGISTICS

YOU ARE A NATURAL SUPPLY CHAIN MANAGEMENT STUDENT IF YOU

Are organized and detail-oriented

Excel in problem-solving and process optimization

Have strong communication and negotiation skills

Are interested in logistics, operations, and global trade

Problem Based Learning (PBL) Approach

Mandatory internship as from year 1

THE SCM EXPERIENCE



Industry-focused training and certifications



Exposure to advanced logistics tools and technologies



Hands-on experience with live supply chain optimization projects



Collaboration with industry experts and mentors

FURTHER STUDY



PhD in Supply Chain Management



MSc in International Business or Operations Management

MOBILITY PARTNERS

- Skemma Business School,
- Université Sorbonne Paris-Nord,
- OMNES Education

EQUIVALENT TRAINING

Licence professionnelle en Gestion de la Chaîne d'Approvisionnement

HEALTH SCIENCES

AT ROUSSEAU HIGHER INSTITUTE OF TECHNOLOGY

BACHELOR OF SCIENCES

MEDICAL LABORATORY SCIENCE

NURSING

MEDICAL DIAGNOSTIC IMAGING AND RADIATION THERAPY

PHYSIOTHERAPY

MASTER OF SCIENCES

NURSE ANESTHESIA

PEDIATRIC NURSING

MIDWIFERY

OUTCOMES IN HEALTH SCIENCES

PATH 1 FURTHER STUDIES



SPECIALIZED MASTER'S OR DOCTORATE PROGRAMS

Enroll in advanced degrees focusing on a specific area like Clinical Research, Advanced Diagnostic Techniques, or Healthcare Management.



PROFESSIONAL CERTIFICATIONS

Obtain certifications tailored to the specialization, such as oncology imaging, advanced physiotherapy techniques, or critical care nursing.



INTERDISCIPLINARY PROGRAMS

Pursue studies in related fields, such as Health Informatics, Public Health, or Biomechanics.

PATH 2 EMPLOYMENT



HEALTHCARE SPECIALIST

Work as a key practitioner in hospitals, clinics, or diagnostic centers, such as a lab technologist, imaging technician, nurse specialist, or physiotherapist.



HEALTH SERVICES COORDINATOR

Take on administrative or management roles in healthcare organizations.



INDUSTRY CONSULTANT

Provide expertise for medical equipment manufacturers, health policy organizations, or training institutions.

PATH 3 ENTREPRENEURSHIP



HEALTH SERVICES START-UP

Launch a business offering home healthcare services, rehabilitation for physiotherapy patients, or mobile diagnostic solutions, etc.



TRAINING AND EDUCATION

Create a training center or online platform for healthcare professionals and students.



HEALTHCARE CONSULTANCY

Offer consulting services for hospitals or clinics, focusing on care management, compliance, or diagnostic practices

COURSE BSc

MEDICAL DIAGNOSTIC IMAGING AND RADIATION THERAPY

3 YEARS
PROGRAMME



EXTENSIVE TRAINING IN
DIAGNOSTIC IMAGING
TECHNIQUES AND RADIATION
THERAPY



STRONG FOCUS ON
PATIENT CARE AND
SAFETY

30
SEATS



HANDS-ON CLINICAL
PRACTICE IN HOSPITALS AND
HEALTHCARE SETTINGS

Using advanced imaging technologies and radiation therapy to diagnose and treat medical conditions. You will contribute to patient care by ensuring accurate diagnoses and effective treatment plans.

HERE, YOU WILL ACQUIRE

- In-depth knowledge of diagnostic imaging methods, including X-rays, CT scans, MRI, and ultrasound.
- Skills in administering radiation therapy for cancer treatment.
- Understanding of medical ethics, patient care, and safety protocols.
- Experience with state-of-the-art imaging equipment and radiation therapy technology.
- Practical experience through internships and clinical placements.

MOBILITY OPPORTUNITIES

Study a semester abroad at one of our international partner institutions, or continue your studies overseas after completing your degree.

Entry-Level Positions	RADIOLOGIC TECHNOLOGIST MEDICAL IMAGING TECHNICIAN
Mid-Level Positions	RADIATION THERAPIST MEDICAL IMAGING SPECIALIST
Advanced Positions	SENIOR RADIOLOGIC TECHNOLOGIST RADIATION ONCOLOGY SPECIALIST
Leadership Roles	HEAD OF RADIOLOGY DEPARTMENT CHIEF RADIATION THERAPIST

YOU ARE A NATURAL
MEDICAL DIAGNOSTIC
IMAGING AND
RADIATION THERAPY
STUDENT IF YOU

Have an interest in
healthcare and
technology

**Possess strong
attention to detail and
accuracy**

Are empathetic and
patient-focused

**Thrive in dynamic,
fast-paced
environments**

**Problem Based
Learning (PBL)
Approach**

**Mandatory
internship
as from year 1**

THE MDIRT EXPERIENCE



Clinical internships and
certifications



Exposure to the
latest imaging and
radiation therapy
technologies



Hands-on training
with
industry-standard
medical equipment



Collaboration with
healthcare profes-
sionals and mentors

FURTHER STUDY



Master of Medical
Imaging



MSc in Radiation
Therapy

MOBILITY PARTNERS

- Skemma Business School,
- Université Sorbonne Paris-Nord,
- OMNES Education

EQUIVALENT TRAINING

Licence professionnelle
en Imagerie Médicale
et Radiothérapie

COURSE **BSc**

MEDICAL LABORATORY SCIENCE

3 YEARS
PROGRAMME



COMPREHENSIVE TRAINING IN
LABORATORY TECHNIQUES
AND DIAGNOSTICS



EMPHASIS ON
CLINICAL PRACTICE
AND PATIENT CARE

30
SEATS



HANDS-ON EXPERIENCE
WITH ADVANCED MEDICAL
EQUIPMENT

Conducting diagnostic tests that play a vital role in patient care. You will be trained to perform laboratory analyses, aiding in disease detection and treatment plans.

HERE, YOU WILL ACQUIRE

- In-depth knowledge of laboratory techniques, including blood testing, microbiology, and pathology.
- Skills in using laboratory instruments for diagnostic testing and analysis.
- Understanding of laboratory safety, quality control, and ethical standards.
- Experience with clinical diagnostics through internships and hands-on laboratory work.
- Proficiency in analyzing and interpreting lab results to assist in medical diagnoses.

MOBILITY OPPORTUNITIES

Study a semester abroad at one of our international partner institutions, or continue your studies overseas after completing your degree.

Entry-Level Positions	MEDICAL LABORATORY TECHNICIAN CLINICAL LABORATORY ASSISTANT
Mid-Level Positions	MEDICAL LABORATORY SCIENTIST CLINICAL LABORATORY SPECIALIST
Advanced Positions	SENIOR LABORATORY SCIENTIST LABORATORY SUPERVISOR
Leadership Roles	LABORATORY MANAGER DIRECTOR OF LABORATORY SERVICES

YOU ARE A NATURAL
MEDICAL
LABORATORY SCIENCE
STUDENT IF YOU

Have an interest in
healthcare and
laboratory work

**Are detail-oriented
and precise**

Enjoy solving complex
problems

**Have strong
communication and
organizational skills**

**Problem Based
Learning (PBL)
Approach**

**Mandatory
internship
as from year 1**

THE MLS EXPERIENCE



Clinical internships and
certifications



Exposure to
cutting-edge laboratory
technologies and
techniques



Hands-on training
in real-world
healthcare settings



Collaboration with
healthcare
professionals and
mentors

FURTHER STUDY



Master in Clinical
Laboratory
Science



MSc in Medical
Diagnostics or
Public Health

MOBILITY PARTNERS

- Skemma Business School,
- Université Sorbonne Paris-Nord,
- OMNES Education

EQUIVALENT TRAINING

Licence professionnelle
en Sciences et Techniques
de Laboratoire Médical

COURSE **BSc**

NURSING

3 YEARS
PROGRAMME



COMPREHENSIVE TRAINING IN PATIENT CARE, CLINICAL PRACTICE, AND MEDICAL PROCEDURES



FOCUS ON PATIENT-CENTERED CARE AND HEALTH PROMOTION

30
SEATS



HANDS-ON EXPERIENCE THROUGH INTERNSHIPS IN HOSPITALS AND HEALTH-CARE SETTINGS

Providing care and support to patients in hospitals, clinics, and communities. You will be trained to manage medical situations, promote wellness, and support patients' physical and emotional needs.

HERE, YOU WILL ACQUIRE

- In-depth knowledge of nursing theories, patient care, and healthcare management.
- Skills in administering medications, performing medical procedures, and providing patient support.
- Understanding of healthcare ethics, legal standards, and patient safety.
- Practical experience through clinical placements in various healthcare environments.
- The ability to work effectively in multidisciplinary teams and with patients from diverse backgrounds.

MOBILITY OPPORTUNITIES

Study a semester abroad at one of our international partner institutions, or continue your studies overseas after completing your degree.

Entry-Level Positions	REGISTERED NURSE NURSING ASSISTANT
Mid-Level Positions	NURSE PRACTITIONER HEALTHCARE MANAGER
Advanced Positions	NURSE EDUCATOR NURSE CONSULTANT
Leadership Roles	DIRECTOR OF NURSING CHIEF NURSING OFFICER (CNO)

YOU ARE A NATURAL NURSING STUDENT IF YOU

Have a compassionate nature and care for others

Are detail-oriented and organized

Can manage stressful situations with calm and empathy

Enjoy working in a team and with patients of all ages

Problem Based Learning (PBL) Approach

Mandatory internship as from year 1

THE MLS EXPERIENCE



Hands-on clinical practice and internships



Exposure to a wide range of nursing specialties and healthcare settings



Training in patient care, medical procedures, and healthcare management



Collaboration with experienced nurses, doctors, and other healthcare professionals

FURTHER STUDY



Master of Nursing



MSc in Healthcare Management or Nurse Practitioner

MOBILITY PARTNERS

- Skemma Business School,
- Université Sorbonne Paris-Nord,
- OMNES Education

EQUIVALENT TRAINING

Licence professionnelle en Soins Infirmiers

COURSE BSc

PHYSIOTHERAPY

3 YEARS
PROGRAMME



EXTENSIVE TRAINING IN
PHYSICAL THERAPY
TECHNIQUES AND
REHABILITATION



FOCUS ON
IMPROVING
MOBILITY AND
QUALITY OF LIFE
THROUGH
THERAPEUTIC

30
SEATS



HANDS-ON CLINICAL
EXPERIENCE WITH PATIENTS
OF ALL AGES

Helping patients recover from injuries and improve their mobility. You will be trained to design rehabilitation programs and guide patients through the recovery process, enhancing their overall quality of life.

HERE, YOU WILL ACQUIRE

- In-depth knowledge of anatomy, kinesiology, and therapeutic exercise techniques.
- Skills in assessing, diagnosing, and treating physical impairments and disabilities.
- Understanding of rehabilitation practices and patient care in various medical conditions.
- Experience with patient assessment, exercise prescription, and physical rehabilitation programs.
- Practical exposure through internships and clinical placements in healthcare settings.

MOBILITY OPPORTUNITIES

Study a semester abroad at one of our international partner institutions, or continue your studies overseas after completing your degree.

Entry-Level Positions	PHYSIOTHERAPY ASSISTANT REHABILITATION AIDE
Mid-Level Positions	PHYSIOTHERAPIST PHYSICAL REHABILITATION SPECIALIST
Advanced Positions	SENIOR PHYSIOTHERAPIST CLINICAL LEAD PHYSIOTHERAPIST
Leadership Roles	PHYSIOTHERAPY MANAGER DIRECTOR OF REHABILITATION SERVICES

YOU ARE A NATURAL
PHYSIOTHERAPY
STUDENT IF YOU

Have a passion for
healthcare and helping
others

**Are patient,
empathetic, and a
good listener**

Have strong
problem-solving and
manual skills

**Enjoy working closely
with patients to
achieve therapeutic
goals**

**Problem Based
Learning (PBL)
Approach**

**Mandatory
internship
as from year 1**

THE PT EXPERIENCE



Hands-on clinical
practice and patient
care



Exposure to a variety of
therapeutic techniques
and rehabilitation
settings



Collaboration with
multidisciplinary teams
in healthcare
environments



Practical learning through
internships and case
studies

FURTHER STUDY



Master of
Physiotherapy



MSc in Sports
Rehabilitation or
Healthcare
Management

MOBILITY PARTNERS

- Skemma Business School,
- Université Sorbonne Paris-Nord,
- OMNES Education

EQUIVALENT TRAINING

Licence professionnelle
en Masso-Kinésithérapie

COURSE MSc

MIDWIFERY

2 YEARS
PROGRAMME



ADVANCED TRAINING IN
MATERNAL AND NEWBORN
CARE



FOCUS ON
PROMOTING SAFE
CHILDBIRTH AND
SUPPORTING
WOMEN
THROUGHOUT
PREGNANCY

30
SEATS



HANDS-ON CLINICAL
PRACTICE IN MATERNITY
AND NEONATAL CARE
SETTINGS

Supporting women through pregnancy, labor, and childbirth, ensuring the well-being of both mother and baby. This program prepares you to provide compassionate care and guidance to women, promoting healthy pregnancies and deliveries.

HERE, YOU WILL ACQUIRE

- In-depth knowledge of obstetrics, childbirth, and neonatal care.
- Skills in managing pregnancy, labor, and postnatal care for women and infants.
- Understanding of evidence-based practices in midwifery and maternal health.
- Practical experience through clinical placements in maternity units and community healthcare settings.
- Proficiency in supporting women and families in making informed choices throughout the childbirth process.

YOU ARE A NATURAL
MIDWIFERY STUDENT
IF YOU

Have a passion for
maternal health and
newborn care

**Are compassionate,
empathetic, and
patient**

Excel in communication
and supporting families
through challenging
times

**Are keen to work in a
rewarding and
hands-on healthcare
profession**

**Problem Based
Learning (PBL)
Approach**

**Mandatory
internship
as from year 1**

MOBILITY OPPORTUNITIES

Study a semester abroad at one of our international partner institutions, or continue your studies overseas after completing your degree.

Entry-Level Positions	MIDWIFE MATERNITY CARE ASSISTANT
Mid-Level Positions	REGISTERED MIDWIFE CLINICAL MIDWIFERY SPECIALIST
Advanced Positions	SENIOR MIDWIFE CONSULTANT MIDWIFE
Leadership Roles	DIRECTOR OF MIDWIFERY SERVICES HEAD OF MATERNITY CARE

THE MW EXPERIENCE



Comprehensive clinical
training and hands-on
experience



Exposure to both
hospital and
community-based
midwifery care



Support from
experienced midwifery
mentors and
practitioners



Collaboration with
multidisciplinary
healthcare teams

FURTHER STUDY



Doctorate in
Midwifery



MSc in Women's
Health or Public
Health

MOBILITY PARTNERS

- Skemma Business School,
- Université Sorbonne Paris-Nord,
- OMNES Education

EQUIVALENT TRAINING

Licence professionnelle
en Maieutique

COURSE MSc

NURSE ANESTHESIA

2 YEARS
PROGRAMME



ADVANCED TRAINING IN ANESTHESIA CARE FOR SURGICAL AND MEDICAL PROCEDURES



FOCUS ON PATIENT SAFETY, PAIN MANAGEMENT, AND CRITICAL CARE DURING ANESTHESIA

30
SEATS



HANDS-ON CLINICAL EXPERIENCE IN ANESTHESIA ADMINISTRATION

Administering anesthesia safely and effectively for patients undergoing surgery or medical procedures. This program prepares you to manage anesthesia care and ensure the well-being of patients in critical care environments.

HERE, YOU WILL ACQUIRE

- Comprehensive knowledge of anesthesia techniques, pharmacology, and patient monitoring.
- Skills in providing anesthesia for a wide range of surgeries and medical interventions.
- Understanding of patient assessment, risk management, and post-anesthesia care.
- Practical experience through clinical placements in operating rooms and critical care units.
- Proficiency in ensuring patient safety and comfort during anesthesia administration.

MOBILITY OPPORTUNITIES

Study a semester abroad at one of our international partner institutions, or continue your studies overseas after completing your degree.

Entry-Level Positions	ANESTHESIA NURSE NURSE ANESTHESIA ASSISTANT
Mid-Level Positions	CERTIFIED REGISTERED NURSE ANESTHETIST (CRNA)
Advanced Positions	SENIOR NURSE ANESTHETIST CLINICAL ANESTHESIA SPECIALIST
Leadership Roles	DIRECTOR OF ANESTHESIA SERVICES HEAD OF ANESTHESIA DEPARTMENT

YOU ARE A NATURAL MIDWIFERY STUDENT IF YOU

Have a passion for maternal health and newborn care

Are compassionate, empathetic, and patient

Excel in communication and supporting families through challenging times

Are keen to work in a rewarding and hands-on healthcare profession

Problem Based Learning (PBL) Approach

Mandatory internship as from year 1

THE NA EXPERIENCE



Extensive clinical training and hands-on experience in anesthesia administration



Exposure to various anesthesia techniques and patient management strategies



Collaborative learning with anesthesiologists, surgeons, and other healthcare professionals



Mentorship from experienced nurse anesthetists

FURTHER STUDY



Doctorate in Nurse Anesthesia



MSc in Critical Care or Pain Management

MOBILITY PARTNERS

- Skemma Business School,
- Université Sorbonne Paris-Nord,
- OMNES Education

EQUIVALENT TRAINING

Licence professionnelle en Anesthésie-Réanimation Infirmière

COURSE MSc

PEDIATRIC NURSING

2 YEARS
PROGRAMME



SPECIALIZED TRAINING IN CHILD HEALTHCARE AND PEDIATRIC NURSING



FOCUS ON PROVIDING COMPASSIONATE CARE TO CHILDREN AND SUPPORTING FAMILIES

30
SEATS



HANDS-ON EXPERIENCE IN PEDIATRIC CARE UNITS AND HOSPITALS

Administering anesthesia safely and effectively for patients undergoing surgery or medical procedures. This program prepares you to manage anesthesia care and ensure the well-being of patients in critical care environments.

HERE, YOU WILL ACQUIRE

- Advanced knowledge in pediatric nursing, child development, and pediatric diseases.
- Skills in assessing, diagnosing, and treating illnesses in infants, children, and adolescents.
- Understanding of pediatric pharmacology, pain management, and pediatric emergency care.
- Practical experience through clinical placements in pediatric hospitals, clinics, and community settings.
- Proficiency in providing holistic and family-centered care to young patients.

MOBILITY OPPORTUNITIES

Study a semester abroad at one of our international partner institutions, or continue your studies overseas after completing your degree.

Entry-Level Positions	PEDIATRIC NURSE PEDIATRIC NURSING ASSISTANT
Mid-Level Positions	REGISTERED PEDIATRIC NURSE PEDIATRIC NURSE SPECIALIST
Advanced Positions	SENIOR PEDIATRIC NURSE CLINICAL PEDIATRIC NURSING SPECIALIST
Leadership Roles	HEAD OF PEDIATRIC NURSING SERVICES DIRECTOR OF PEDIATRIC CARE

YOU ARE A NATURAL PEDIATRIC NURSING STUDENT IF YOU:

Have a passion for working with children and their families

Are empathetic, patient, and compassionate

Possess strong clinical skills and a keen eye for detail

Thrive in dynamic healthcare settings and are focused on patient well-being

Problem Based Learning (PBL) Approach

Mandatory internship as from year 1

THE PN EXPERIENCE



Comprehensive clinical training in pediatric healthcare



Exposure to pediatric diseases, conditions, and treatment protocols



Collaboration with multidisciplinary teams in hospitals and healthcare settings



Mentorship from experienced pediatric nurses and healthcare professionals

FURTHER STUDY



Doctorate in Pediatric Nursing



MSc in Child Health Nursing or Pediatric Critical Care

MOBILITY PARTNERS

- Skemma Business School,
- Université Sorbonne Paris-Nord,
- OMNES Education

EQUIVALENT TRAINING

Licence professionnelle en Soins Infirmiers Pédiatriques

TALENT TRANSFORMATION PROCESS

Realize your dreams with RHIT. Through our innovative Problem-Based Learning (PBL) approach, students engage in impactful projects that mirror real-world challenges. Our Talent Transformation Process connects you to top industry opportunities with personalized guidance, skills workshops, and professional networking. RHIT is committed to equipping you for success in today's global job market.



Hands-On Industry Training

Gain professional skills through internships, PBL projects, and learning expeditions.



Entrepreneurship and Innovation

Develop business acumen with specialized entrepreneurship courses.



Profile Enhancement

Build standout resumes, soft skills, and professional presentation abilities.



Real-World Experience

Explore global opportunities with international mobility and industry connections.

100%
guaranteed



**INTERSHIP
PLACEMENT**

**SOCIAL
IMPACT**

**SUMMER
CAMP**

ARTS

LEISURE

SPORTS

PBL

BROADEN HORIZONS WITH LEARNING EXPEDITIONS

Our learning expeditions offer students a unique international experience, providing the opportunity to visit partner universities abroad. During these trips, students present their projects, exchange ideas, and benchmark their skills against peers from around the globe. These enriching journeys foster global awareness, inspire innovation, and build confidence in an increasingly interconnected world.



RHIT's bilingual program uniquely prepared me for global opportunities by mastering English and French. Collaborative, entrepreneurial teaching fosters responsibility and innovation, empowering us to excel internationally

SEROUR ALAIN
Student in Foundation
Engineering Course



Studying at RHIT has been a transformative experience for me. The problem-based learning approach encourages us to think critically and solve real-world challenges. With access to video conferences featuring experts and skill development programs, I feel connected to a broader world of knowledge.



KETCHA ALEX
Bachelor in Business
Administration and
Management



LIFE @ RHIT

A supportive environment for a vibrant and fulfilling student life

RHIT'S STUDENT CLUBS
NURTURE CREATIVITY, TEAMWORK, AND LEADERSHIP THROUGH ENGAGING ACTIVITIES.



SPORTS
ENCOURAGING TEAMWORK AND PHYSICAL WELL-BEING THROUGH A VARIETY OF SPORTS ACTIVITIES.



LEARNING EXPEDITIONS
EXPLORE REAL-WORLD APPLICATIONS THROUGH GUIDED FIELD TRIPS AND INDUSTRY VISITS.



SOCIAL IMPACT ACTIVITIES
LEARNING HUMILITY AND SHARING TO BECOME SOCIALLY RESPONSIBLE LEADERS.

Learn, Create, Innovate.

ACADEMIC MENTOR
University of Buea

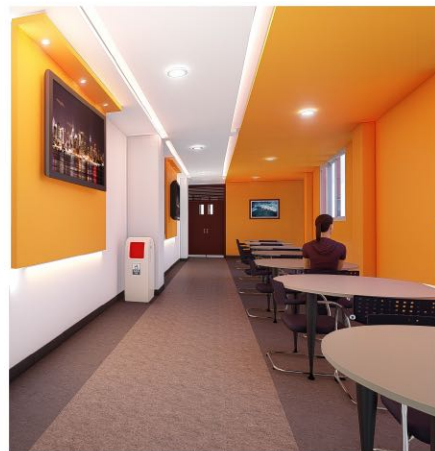

ULTRAMODERN INFRASTRUCTURE

Ultra-fast low latency communication network

Highly advanced, state-of-the-arts physical and technological system

Laboratories equipped with cutting-edge technology



ACADEMIC MENTOR
University of Douala

ONLINE REGISTRATION

1

On the web site
**www.rousseau
higherinstitute.org**
Fill in the form

2

Indicate the number of courses to which you are applying for
Administrative fees:
15 000 FCFA
(5,000 FCFA for each additional training choice)*

3

Make payment via your **phone** by dialling : ***126*4#** enter the merchant code **724423**. Then enter the **amount** according to the number of training options you wish to compete for.

FILE CONSTITUTION

- A certified photocopy of a birth certificate issued within the last three months
- A certified photocopy of the diploma qualifying you to take the entrance exam (e.g., Baccalauréat, GCE A-Level, or equivalent) academic years
- Two recent color passport-sized photographs (4x4 cm)
- A stamped A4 envelope with the candidate's address
- A receipt confirming payment of the psychotechnical test fee

ISEN

QUEST

UNIVERSITÉ
**SORBONNE
PARIS NORD**

IUT Villetaneuse
Université Sorbonne Paris Nord

IMT Mines Albi-Carmaux
Ecole Mines-Télécom

ENIT
ECOLE NATIONALE D'INGÉNIEURS DE TARDES

skema
BUSINESS SCHOOL



OMNES
EDUCATION

In cooperation with
BRITISH COUNCIL

IELTS
Registration Centre

achieve more
SAT

UCAS
We are a UCAS registered centre



EPA ETS Preferred Associate™

ETS TOEIC
ETS TFI

LE PETIT ROUSSEAU
Complexe Scolaire Bilingue



Glotelho
ECOMMERCE



satsuru
Think Africa Think Us

Shift
Zero Carbon Buildings for All



BIM-MOS

Maxwell Technologies

COCIC
S.A.R.L.

HEAVY DUTY ENGINEERING
S.A.R.L.

34 AVENUE DE L'INDEPENDANCE,
2351 HOTEL DE L'AIR, BONAPRISO,
P.O. BOX 5321, DOUALA, CAMEROON

(237) +237 681 89 83 78 / 654 92 22 85
www.rousseauhigherinstitute.org





(237) +237 681 89 83 78 / 692 54 42 32
www.rousseauhigherinstitute.org
infos@rousseauhigherinstitute.org

